



DEPARTMENT OF ENGINEERING AND PLANNING  
One Spring Street  
Newton, New Jersey 07860  
973-579-0430  
[dpw@sussex.nj.us](mailto:dpw@sussex.nj.us)  
*John C. Risko, P.E., P.L.S., P.P.*  
*Division Director/Assistant County Engineer*

## CR 517 – Maple Grange Intersection

**Distributed: July 5, 2012**

### Project Lead Agency: Vernon Township

Sussex County is convening the below basic project information. This information has been received from Vernon Township. More detailed and accurate information can be obtained by contacting Vernon Township.

Up-to-Date Information will be made available through the [Vernon Township Police Facebook page](#).

### Project Description:

**Improvement to the intersection of County Route 517 – Maple Grange – Lounsberry Hollow Roads, Vernon**

This joint Vernon Township/Sussex County project provides for safety upgrades to the intersection of CR 517-Maple Grange Rd-Lounsberry Hollow Rd.

### Schedule:

**Schedule of Work:**

**The Project is scheduled to begin on or about Tuesday July 17, 2012.**

**The work is expected to continue through Mid to late September 2012.**

### Contact Information:

Vernon Township is the lead agency for this project.

Project inquiries can be directed to the Municipal Engineer.

### Traffic Impacts:

**EXPECT DELAYS.**

**Work will be conducted under single-lane closures as well as a 5-day full closure. The full closure is anticipated to occur mid to late August.**

**During the closure a detour will be posted.**



DEPARTMENT OF ENGINEERING AND PLANNING  
One Spring Street  
Newton, New Jersey 07860  
973-579-0430  
[dpw@sussex.nj.us](mailto:dpw@sussex.nj.us)  
John C. Risko, P.E., P.L.S., P.P.  
Division Director/Assistant County Engineer

## CR 517 – Maple Grange Intersection

Distributed: July 5, 2012

### Project Key Map:

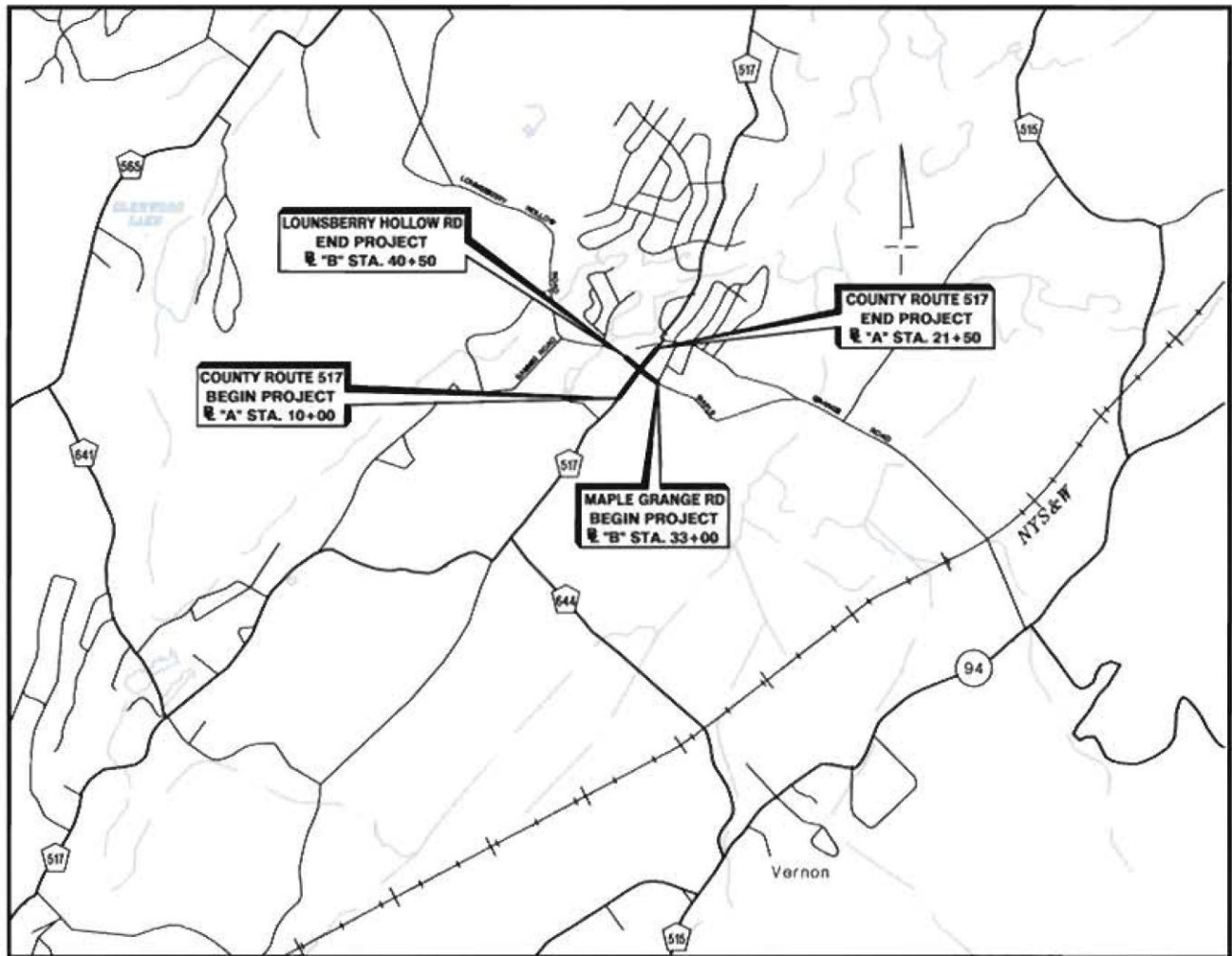

**KEY MAP**



DEPARTMENT OF ENGINEERING AND PLANNING  
 One Spring Street  
 Newton, New Jersey 07860  
 973-579-0430  
[dpw@sussex.nj.us](mailto:dpw@sussex.nj.us)  
 John C. Risko, P.E., P.L.S., P.P.  
 Division Director/Assistant County Engineer

**CR 517 – Maple Grange Intersection**

**Distributed: July 5, 2012**

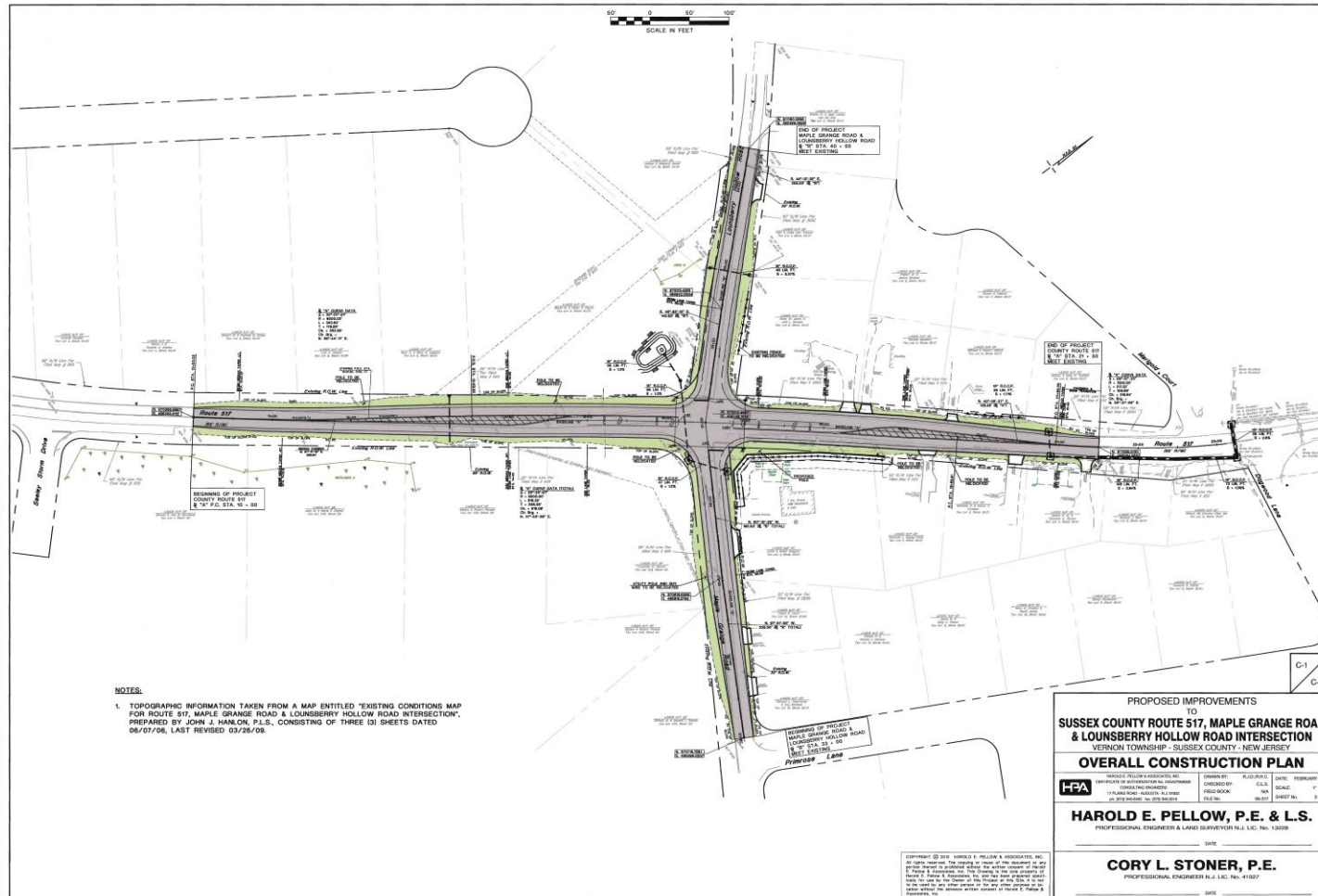

X:\Roads\000\PAVING\Pave 2011\03 Const\10 Corr\20 Notices\05 Pub Outrch\20120430\_NTC\_2011 Pave.doc